

5.1 CREATIVITY WAY CONCEPT - SITE PLAN

A site plan diagram illustrating the extent of the Creativity Way and its position within the historic campus and 6th Street.

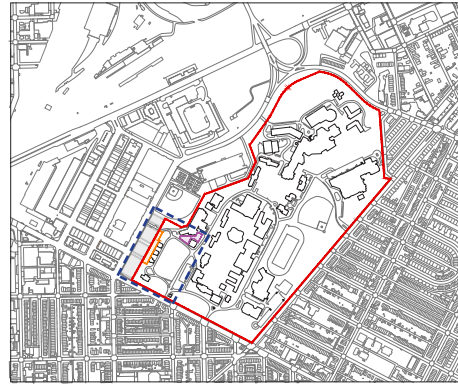

KEY

1. House 1
2. Ballard House
3. Fay House
4. Denison House
5. Kellogg Conference Center
6. Peikoff Alumni House
7. Olmsted Green
8. 6th St Parcel 1
9. 6th St Parcel 2A1
10. 6th St Parcel 2A2
11. 6th St Parcel 2B
12. Miller Memorial

- A. Creativity Way
- B. Tapscott Street
- C. 'Green Finger'
- D. Morse Street

 Creativity Way Outline
(Approximately 20,000SF)

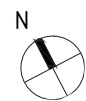

0' 20' 40' 80' 120'

6th Street NE



Miller Memorial

Florida Av NE

5.1 CREATIVITY WAY CONCEPT - SITE PLAN

A site plan diagram illustrating the proposed Conservatory building which is currently under review by Gallaudet University.

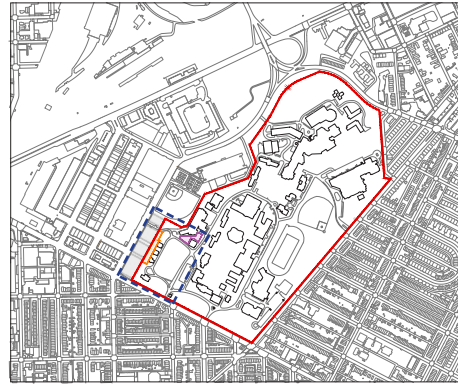

KEY

1. House 1
2. Ballard House
3. Fay House
4. Denison House
5. Kellogg Conference Center
6. Peikoff Alumni House
7. Olmsted Green
8. 6th St Parcel 1
9. 6th St Parcel 2A1
10. 6th St Parcel 2A2
11. 6th St Parcel 2B
12. Miller Memorial

- A. Creativity Way
- B. Tapscott Street
- C. 'Green Finger'
- D. Morse Street

 Creativity Way Outline
(Approximately 20,000SF)

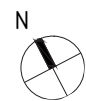

0' 20' 40' 80' 120'

Note: The Conservatory is a concept that is currently under review by GU and will be the subject of a future Campus Plan application.

6th Street NE



Miller Memorial

Florida Av NE

5.2 CREATIVITY WAY CONCEPT - ISOMETRIC

An isometric diagram illustrating the extent of the Creativity Way and its position within the historic campus and 6th Street.

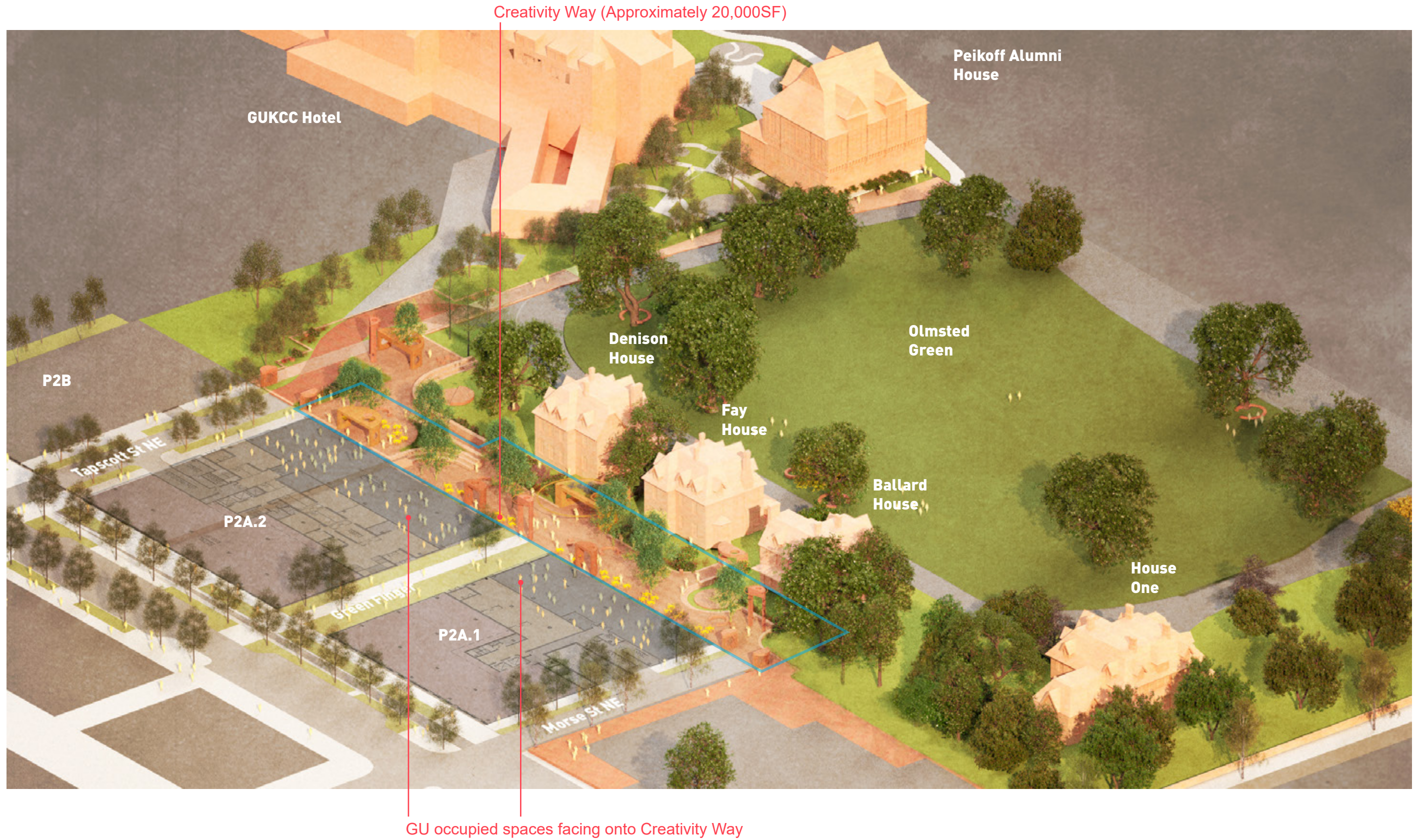

5.2 CREATIVITY WAY CONCEPT - ISOMETRIC

An isometric diagram illustrating the proposed Conservatory building which is currently under review by Gallaudet University.

Note: The Conservatory is a concept that is currently under review by GU and will be the subject of a future Campus Plan application.

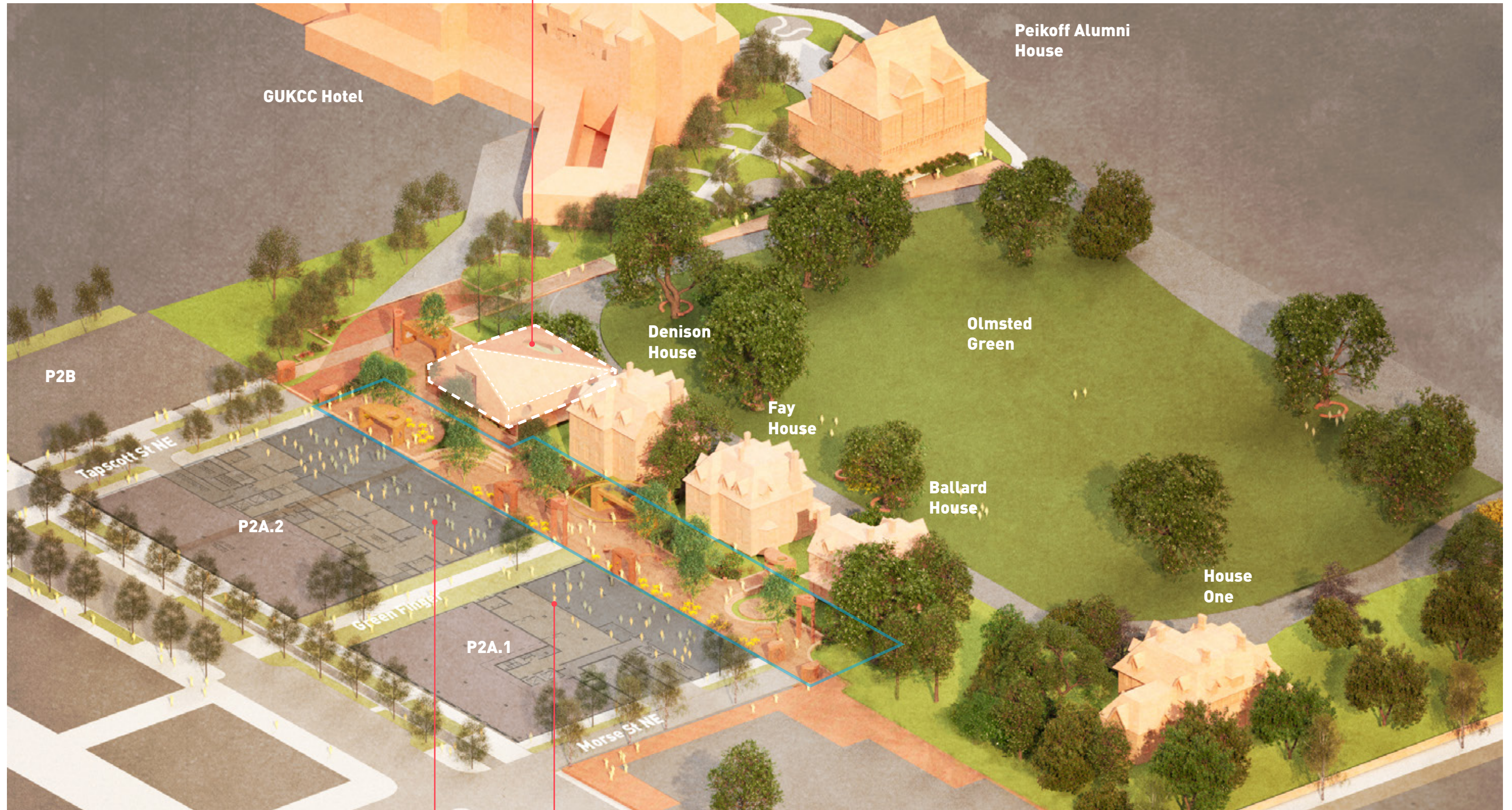

GU occupied spaces facing onto Creativity Way

5.3 CREATIVITY WAY CONCEPT - CROSS SECTION

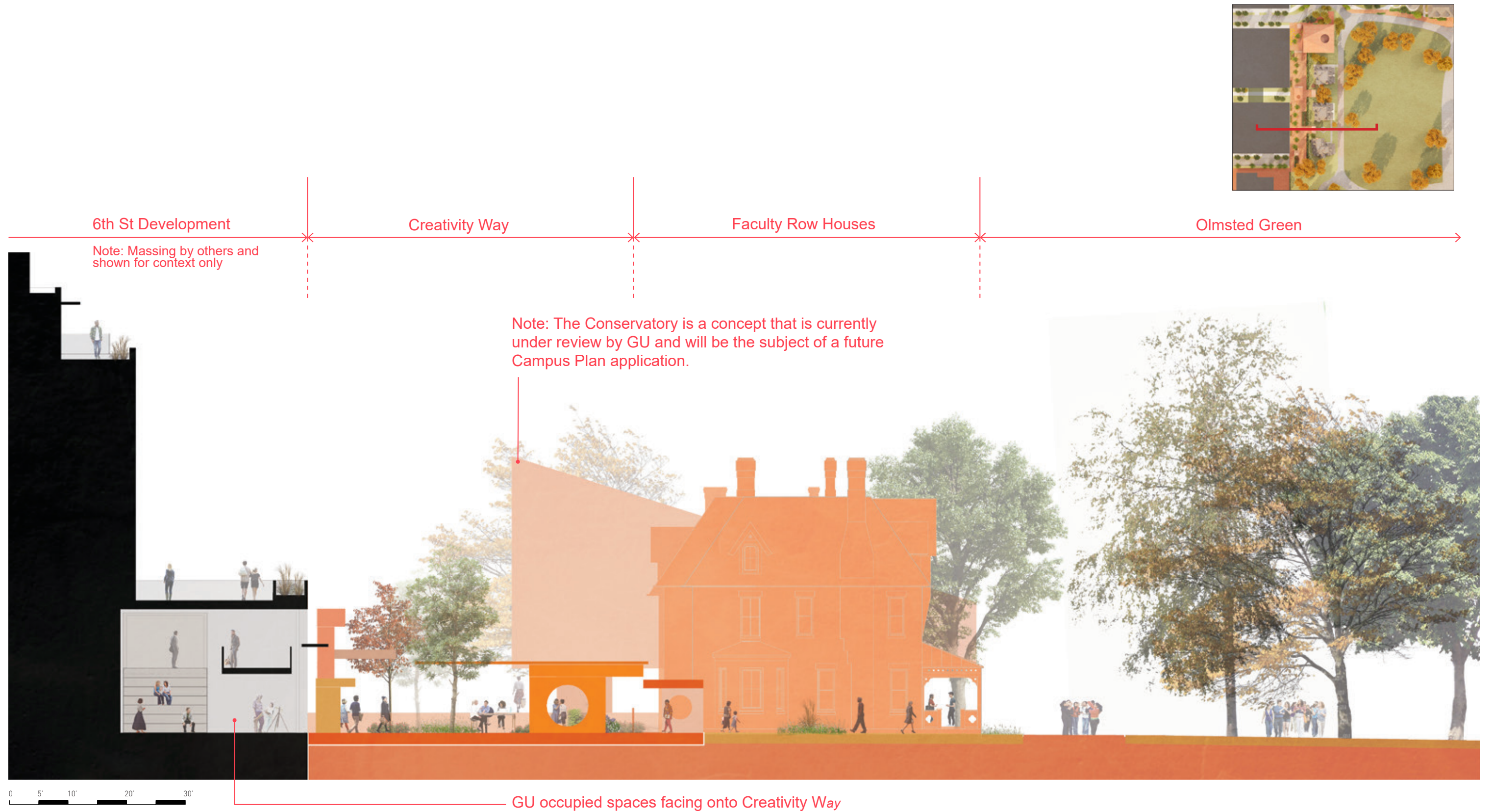

5.4 CREATIVITY WAY & PROPOSED CAMPUS SECURITY STRATEGY

A site plan diagram illustrating the extent of the proposed Creativity Way & Campus security lines, during different times of occupation.

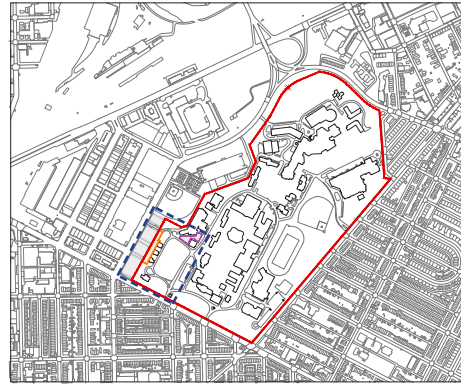

KEY

1. House 1
2. Ballard House
3. Fay House
4. Denison House
5. Kellogg Conference Center
6. Peikoff Alumni House
7. Olmsted Green
8. 6th St Parcel 1
9. 6th St Parcel 2A1
10. 6th St Parcel 2A2
11. 6th St Parcel 2B
12. Miller Memorial

- A. Creativity Way
- B. Tapscott Street
- C. 'Green Finger'
- D. Morse Street

— West side Campus security: night-time use



0' 20' 40' 80' 120'

6th Street NE



Florida Av NE

5.4 CREATIVITY WAY & PROPOSED CAMPUS SECURITY STRATEGY

An example of an indicative security strategy for the western edge of Creativity Way at Tapscott St. Final details subject to review and agreement with the University.

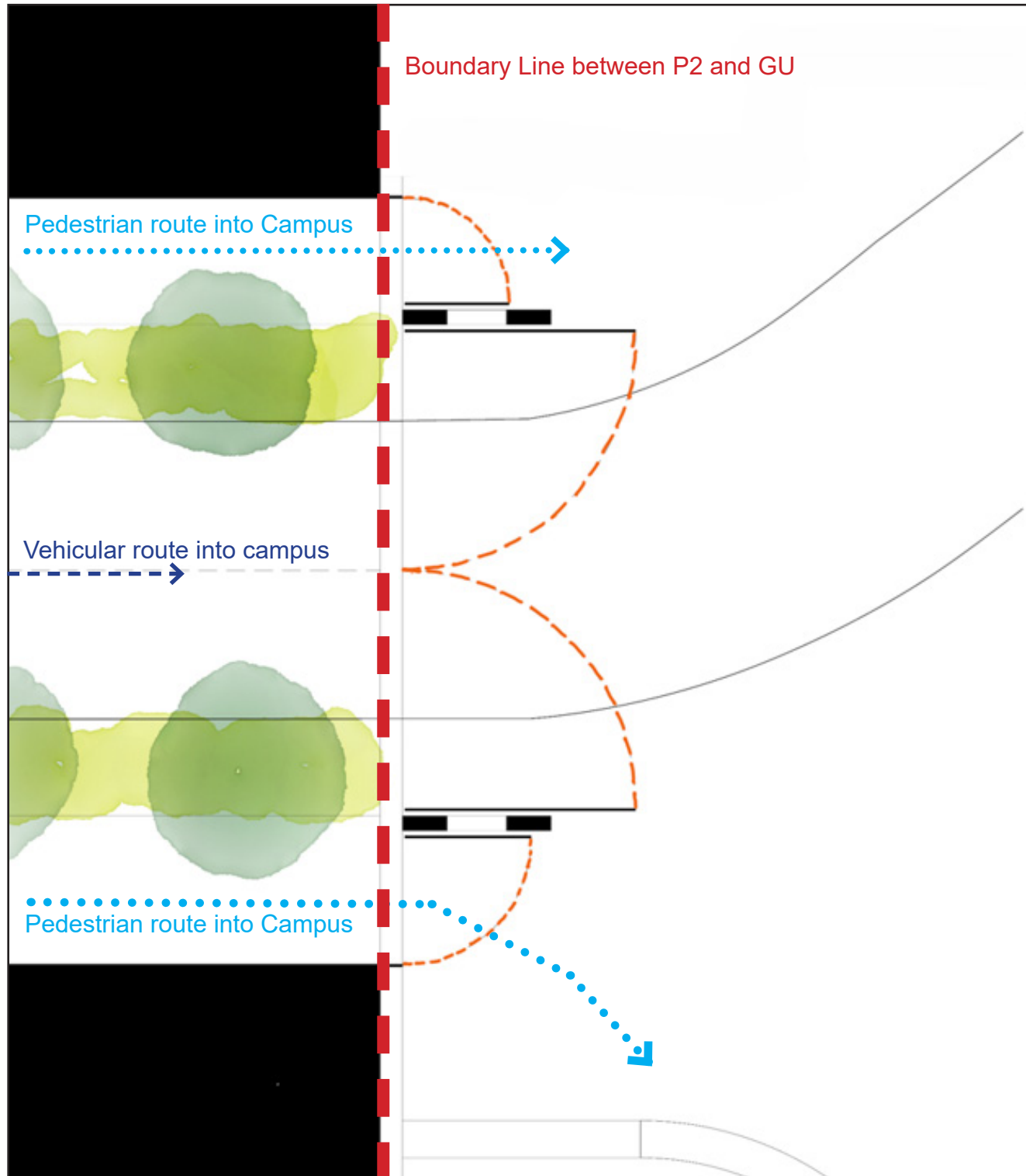

A diagrammatic sketch indicating the campus security strategy at Tapscott St - showing how the gates are intended to swing backwards to minimise visual obstruction.



Night-time view looking towards the northern end of Creativity Way and the entrance into the Campus from Tapscott St - with the gates closed.

5.5 CREATIVITY WAY CONCEPT - DETAILED PLAN

Note: The design and materials of Creativity Way are still under review and subject to further refinement.



KEY

1. Fay House
2. Ballard House
3. CW Gateway
4. 6th St Parcel 2A1

Materials/Planting

- A. Mix of stone and brick pavers with tactile paving at transitions
- B. Stabilized decomposed granite
- C. Cast-in-place concrete edges with embedded planters
- D. Soft and impervious landscaping
- E. Trees (species to be confirmed)

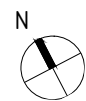

0' 3' 6' 9' 12'



6th St Development

Creativity Way

5.6 CREATIVITY WAY CONCEPT - HARDSCAPE PRECEDENTS

The following images illustrate the style and character of the hard landscaping that we envision for the Creativity Way project.

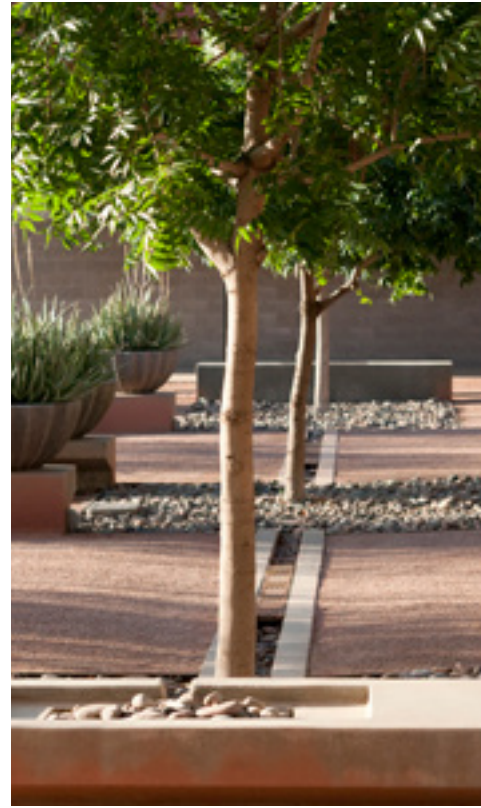

5.7 CREATIVITY WAY CONCEPT - PLANTING PRECEDENTS

The following images illustrate the style and character of the planting that we envision for the Creativity Way project.

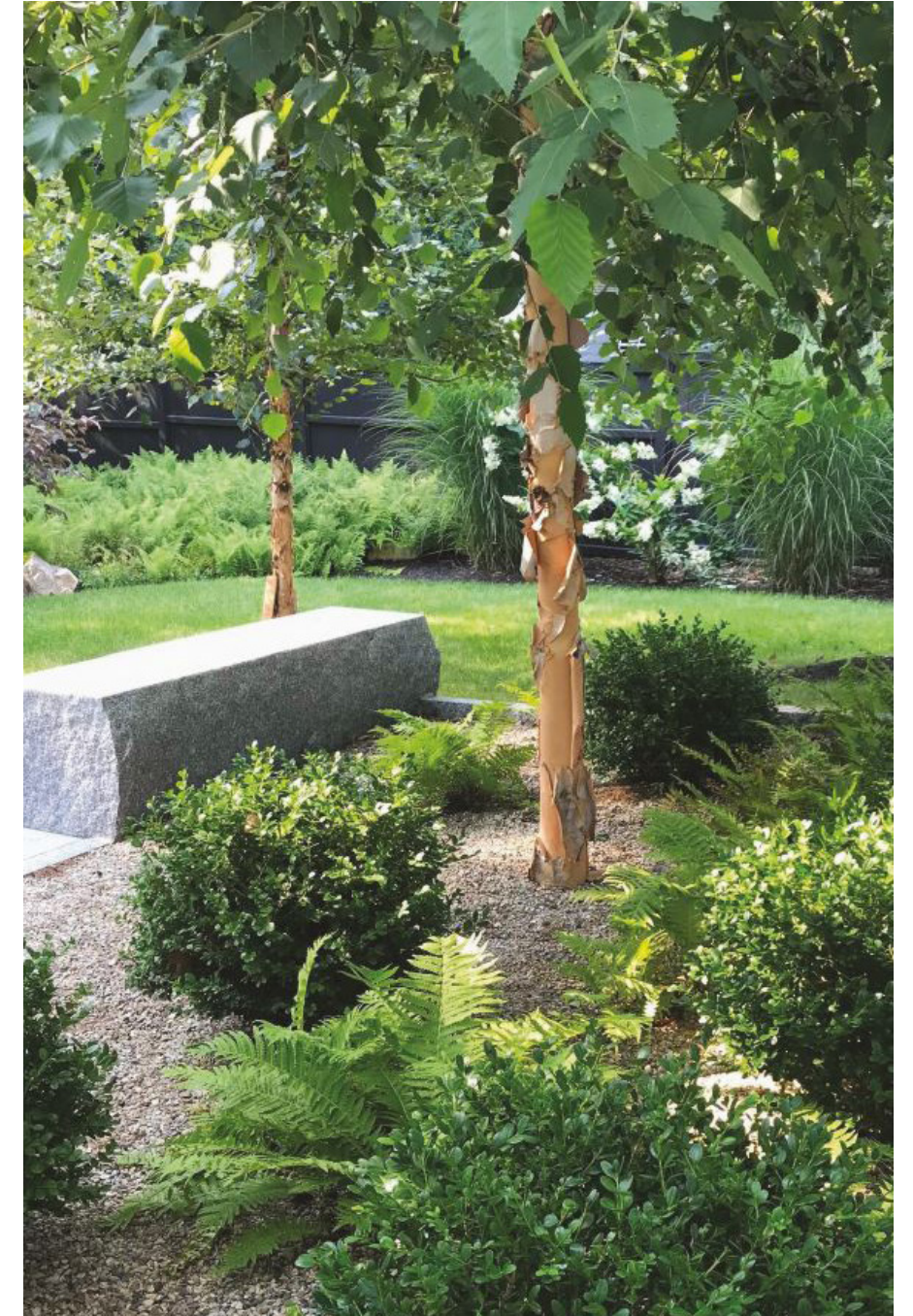

5.7 CREATIVITY WAY CONCEPT - PLANTING PRECEDENTS



5.8 CREATIVITY WAY CONCEPT - WAYFINDING + ARTWORK PRECEDENTS

The following images demonstrate some examples of wayfinding that could be envisioned for the three entrance routes into the Campus.

The images also illustrate the potential to work with artists to help represent a number of diverse user-groups.

The image in the centre of the page illustrates how the entrance portals could be utilised to hang banners and other signages as well as serving the purpose of way-finding for the general public.



View illustrating event signage attached to Creativity Way structure, visible from 6th Street.

